

CFMN-200CAC/15-AF-H

Specifications

Capacity C_{max} (nominal)	200 pF
Voltage (Peak Test U_{pt} / Peak Working U_{pw})	15 kV / 9 kV
Capacity Tolerance	2%
Max. Current I_{max} at 13.56 MHz with	107 Arms
Conduction Cooling	20 W
Net Weight	0.4 kg

I_{max} at 25°C ambient and 125°C surface temp. for convection and conduction (20 W) cooling

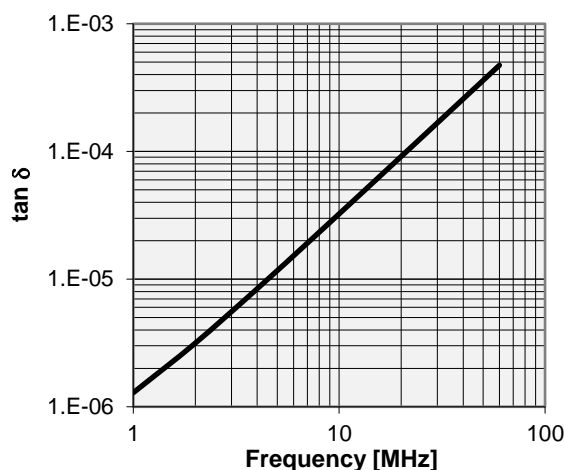
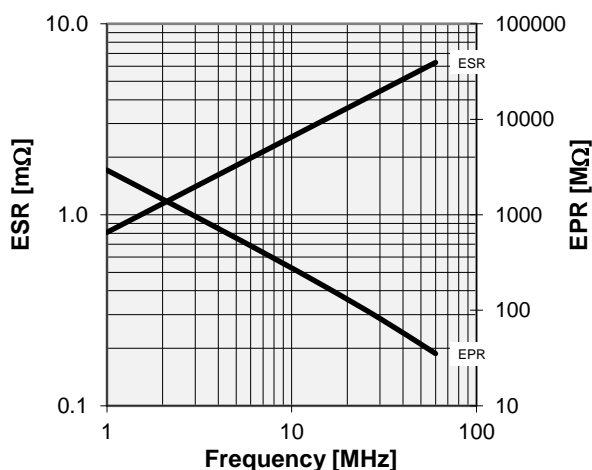
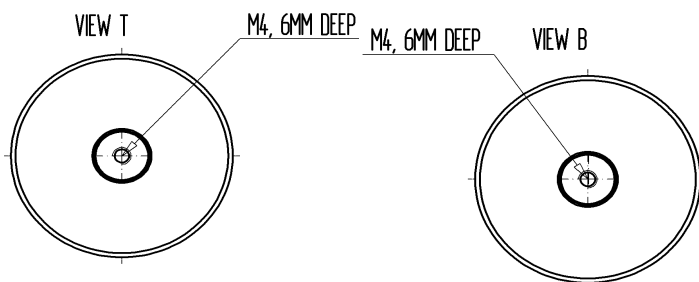
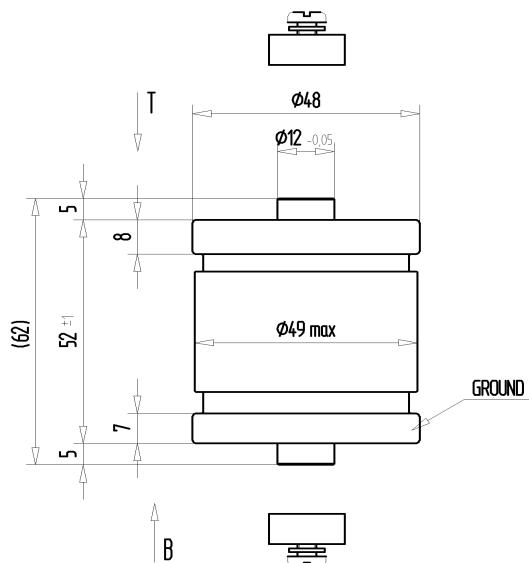
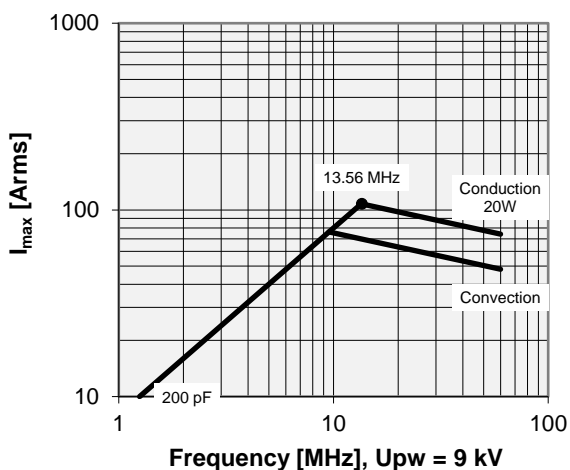

Special Features:
 Special C-Curve / Special Capacity Tolerance,
 RoHS Compliant

Note:
 Technical information in Service Bulletin
 SB-52 must be considered
 Subject to change without prior notice