

CFMN-210CAC/15-AF-F

Specifications

Capacity C_{max} (nominal)	210 pF
Voltage (Peak Test U_{pt} / Peak Working U_{pw})	15 kV / 9 kV
Capacity Tolerance	3%
Max. Current I_{max} at 13.56 MHz with	113 Arms
Conduction Cooling	50 W
Net Weight	0.4 kg

I_{max} at 25°C ambient and 125°C surface temp. for convection and conduction (50 W) cooling

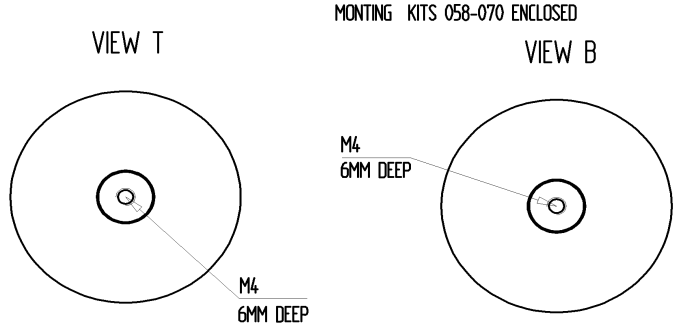
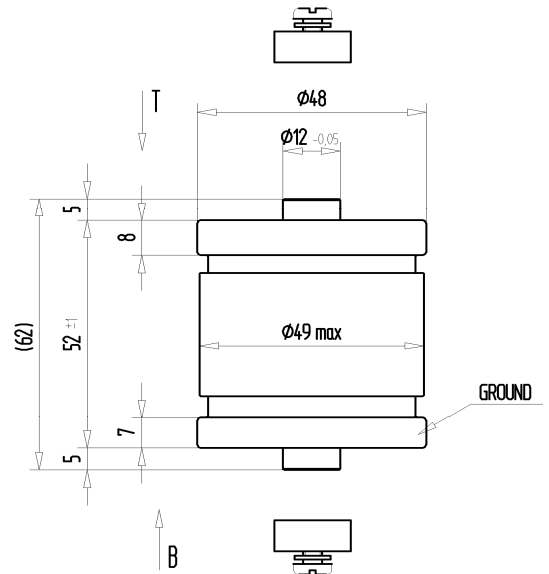
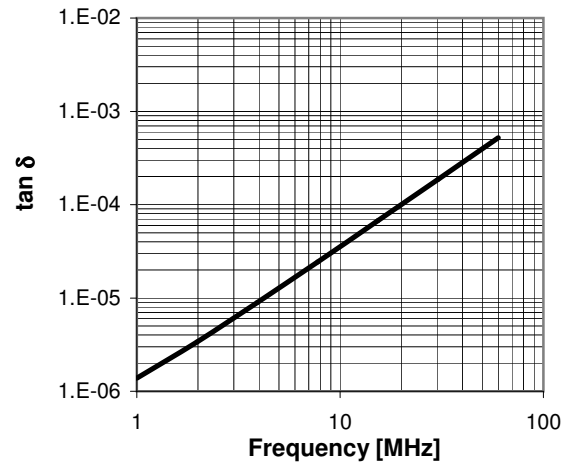
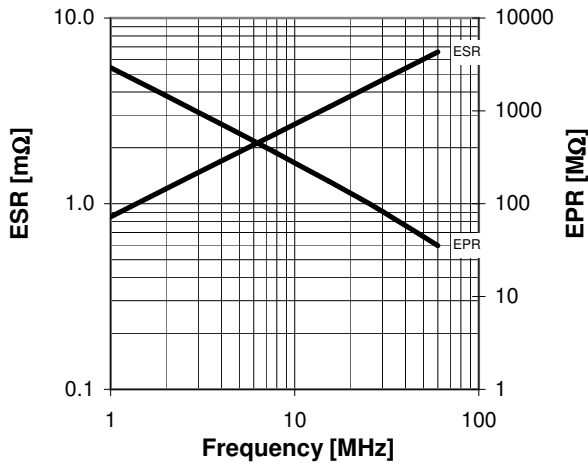
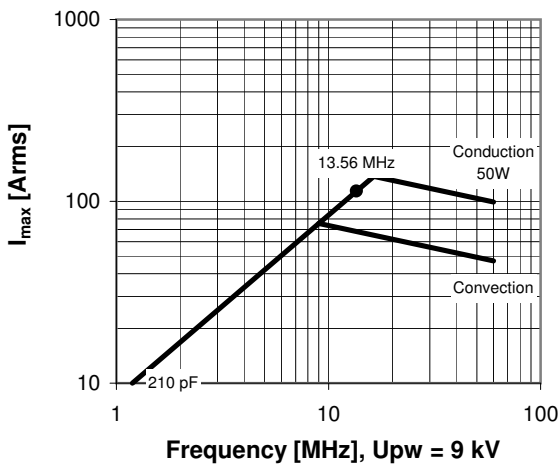

Special Features:

Capacity Tolerance 3%