

CFMN-210CAC/15-AF-G

Old Type Designation: MC1C-210E

Specifications	
Capacitance C_{max} (nominal)	210 pF
Voltage (Peak Test U_{pt} / Peak Working U_{pw})	15 kV / 9 kV
Capacitance Tolerance	5%
Max. Current I_{max} at 13.56 MHz with Conduction Cooling	113 Arms
Net Weight	0.4 kg

I_{max} at 25°C ambient and 125°C surface temp. for convection and conduction (50 W) cooling

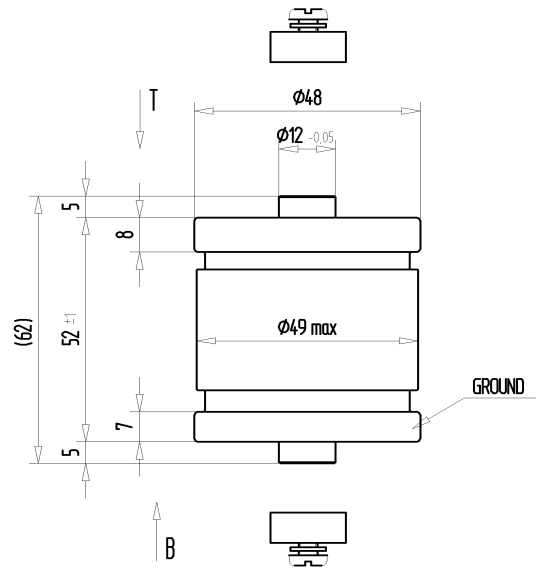
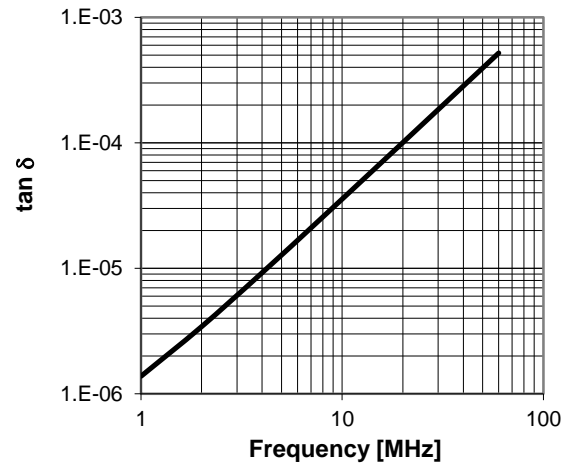
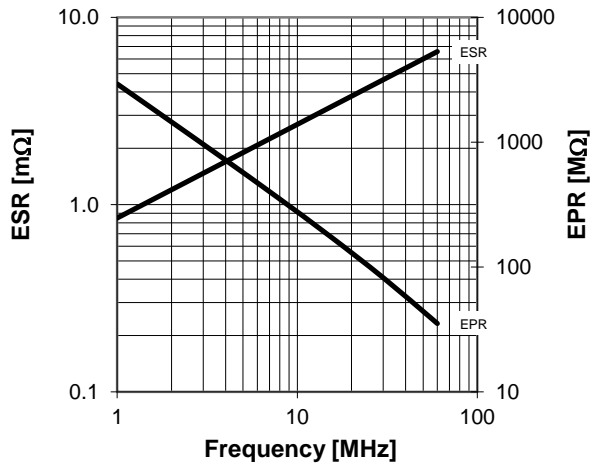
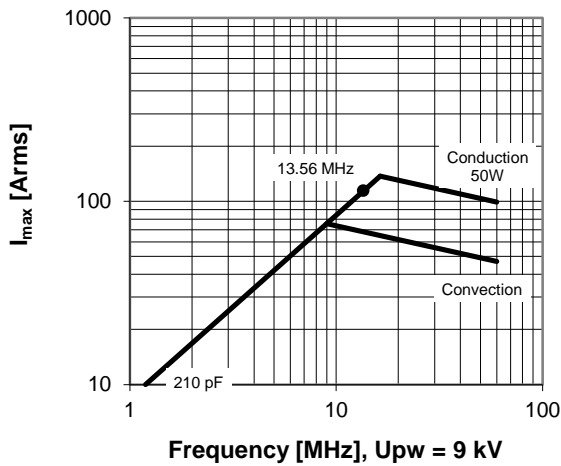

MONTING KITS 058-070 ENCLOSED

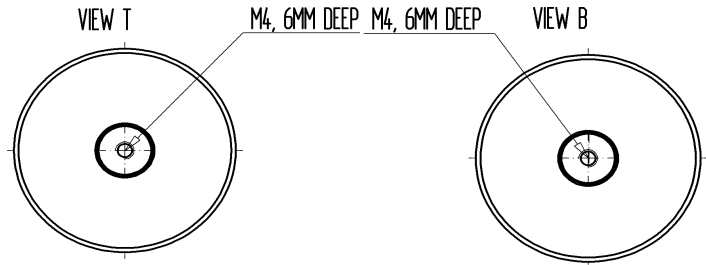

Special Features:
Capacity Tolerance 5%, RoHS Compliant

Subject to change without prior notice

Note: Technical information in Service Bulletin SB-52 must be considered