

# CFNA-1000BAC/40-MA-G

Old Type Designation: CF2C-1000F

## Specifications

|                                                       |               |
|-------------------------------------------------------|---------------|
| Capacity $C_{max}$ (nominal)                          | 1000 pF       |
| Voltage (Peak Test $U_{pt}$ / Peak Working $U_{pw}$ ) | 40 kV / 24 kV |
| Capacity Tolerance                                    | 5%            |
| Max. Current $I_{max}$ at 13.56 MHz with              | 162 Arms      |
| Conduction Cooling                                    | 50 W          |
| Net Weight                                            | 3 kg          |
| Mounting Flange (optional)                            | 058-010       |

$I_{max}$  at 25°C ambient and 125°C surface temp. for convection and conduction (50 W) cooling

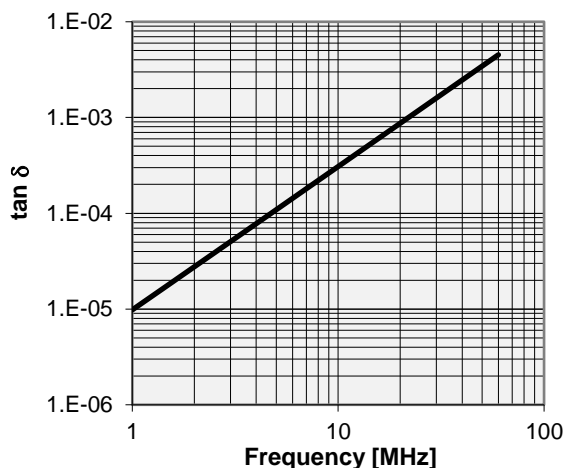
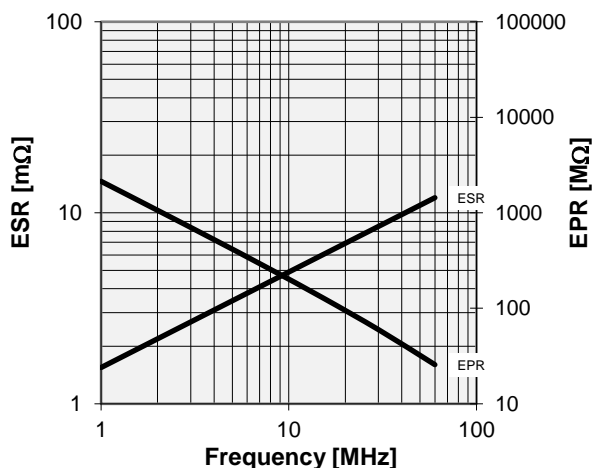
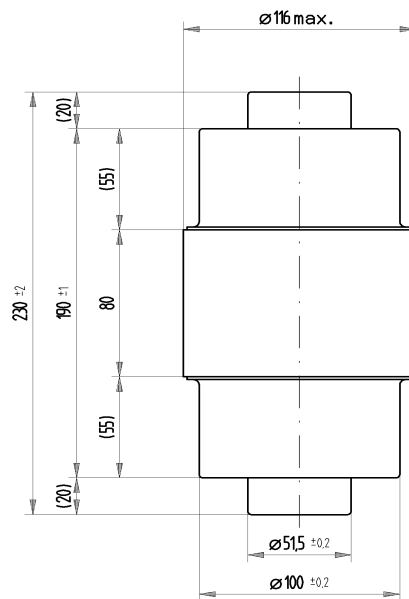
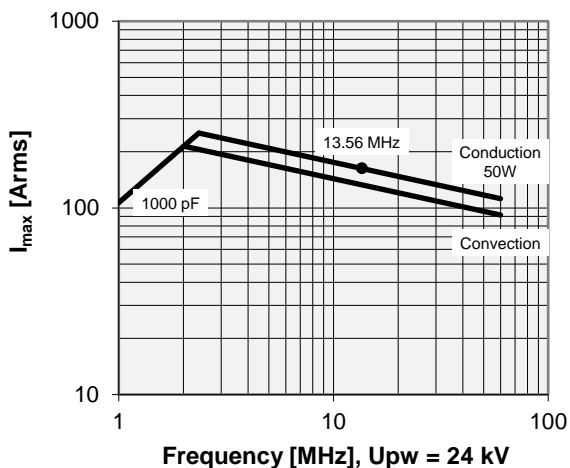

**Special Features:**  
 Capacity Tolerance 5%

Note:  
 Technical information in Service Bulletin  
 SB-52 must be considered  
 Subject to change without prior notice