

CMSM-750AC/12-B-F

Capacitor Specifications

Capacitance C_{max} (nominal)	750 pF
Capacitance C_{min} (nominal)	25 pF
Voltage (Peak Test U_{pt} / Peak Working U_{pw})	12 kV / 7.2 kV
Ground to variable end insulation (Peak Test)	10 kV
Capacitance Tolerance (linear Range)	10%
Max. Current I_{max} at 13.56 MHz with	111 Arms
Conduction Cooling	40 W
Self Inductance	≤ 8 nH
Capacitance per 100 steps	28.2 pF
Mechanical stop at < 25 pF at ~ -200 full steps	1.8 kg
Ground to variable end capacitance	≤ 5 pF

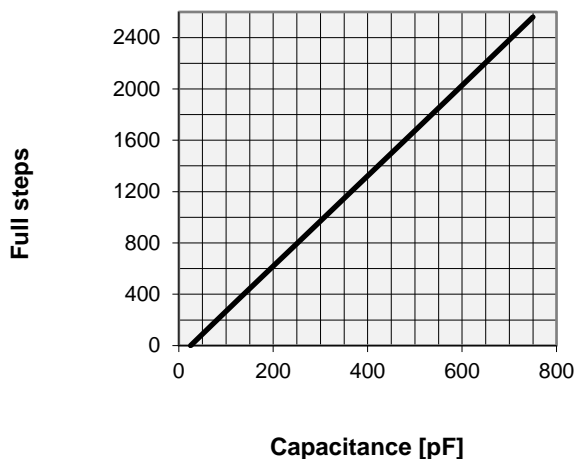
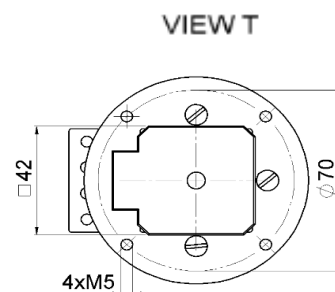
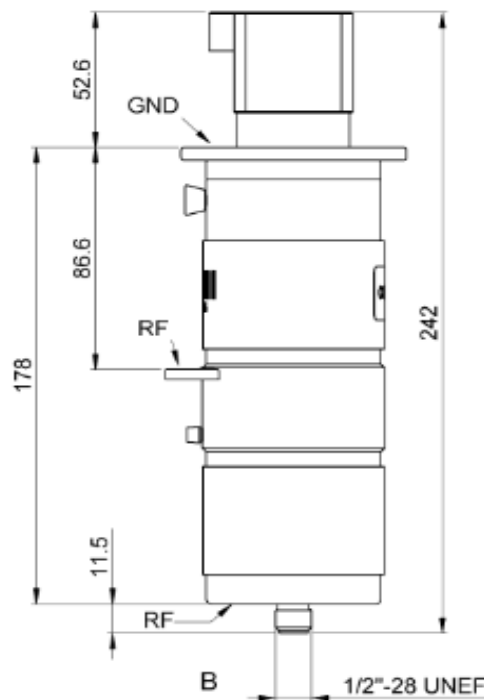
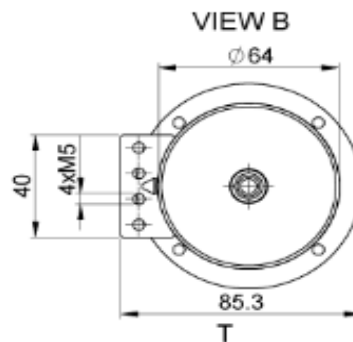

I_{max} at 25°C ambient and 125°C surface temp. for convection and conduction (40 W) cooling

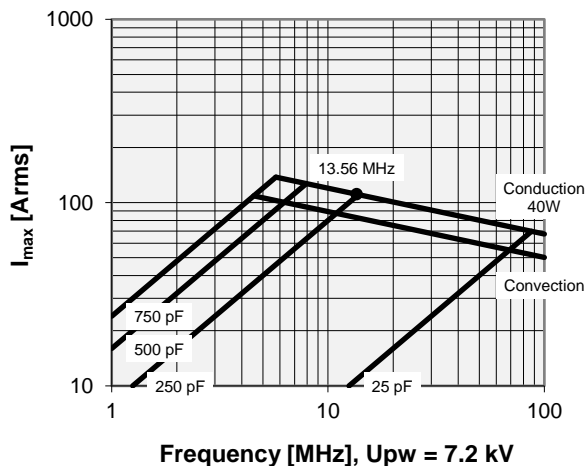

Note:

Technical information in Service Bulletin
 SB-52 and SB-60 must be considered
 Subject to change without prior notice

CMSM-750AC/12-B-F

Full steps	Nominal Capacitance [pF]	Tolerance
0	25.0	10%
356	125.0	10%
796	250.4	10%
1238	375.9	10%
1678	501.0	10%
2120	626.0	10%
2560	750.0	10%

Mechanical stop at < 25 pF at ~ -200 full steps
 Mechanical stop at > 750 pF at ~ 2560 full steps

Self inductance and resonance frequency

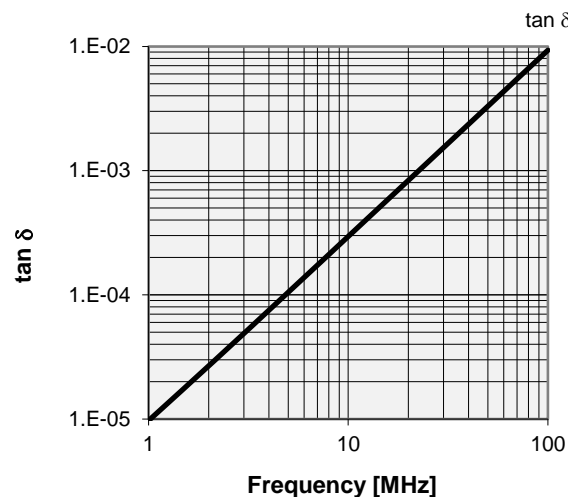
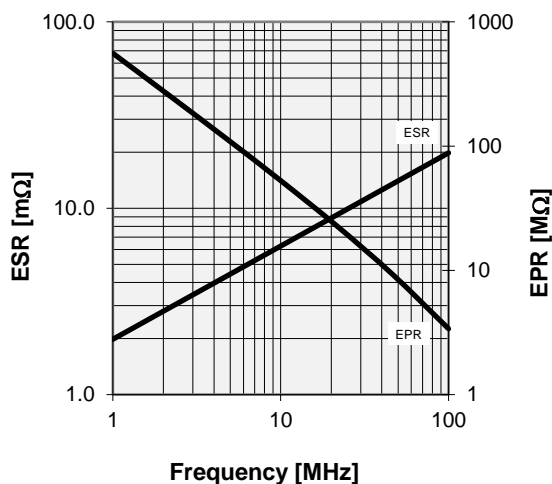
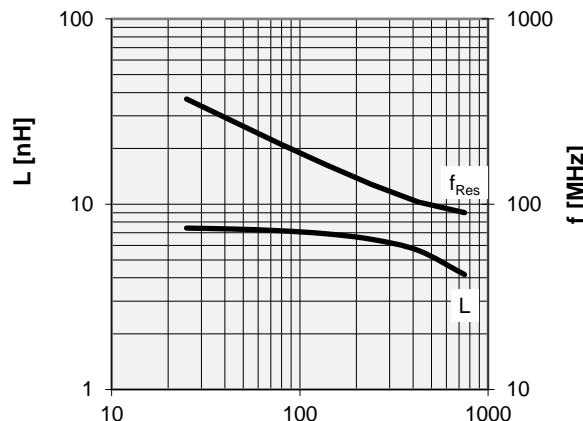

Special Features:
RoHS Compliant

General handling information for the integrated drive
 When installing or removing the integrated drive, extreme care must be taken to avoid damage to the body of the integrated drive. Although the integrated drive look very rugged from the outside it must be remembered that, due to the brazing process used to join ceramic and copper, the copper is in a soft, annealed condition and is therefore highly susceptible to mechanical deformation. For this reason, any rough handling, like machining of the flanges, must be avoided. Use existing threads and holes for fixation.

General installation information for the integrated drive
 For all integrated drives we recommend that one side be mounted non-rigid to prevent excessive thermomechanical and external forces from acting on the capacitor.

Note:
 Technical information in Service Bulletin
 SB-52 and SB-60 must be considered
 Subject to change without prior notice