

## CVNA-1000DC/15-AJA-F

Old Type Designation: CV1C-1000N

### Specifications

Capacity $C_{max}$ (nominal)	1000 pF
Capacity $C_{min}$ (nominal)	15 pF
Voltage (Peak Test $U_{pt}$ / Peak Working $U_{pw}$ )	15 kV / 9 kV
Capacity Tolerance (linear Range)	3%
Max. Current $I_{max}$ at 13.56 MHz	80 Arms
Self Inductance	$\leq 18$ nH
Capacitance per turn	46.2 pF/turn
Torque	$\leq 0.3$ Nm
Net Weight	3 kg

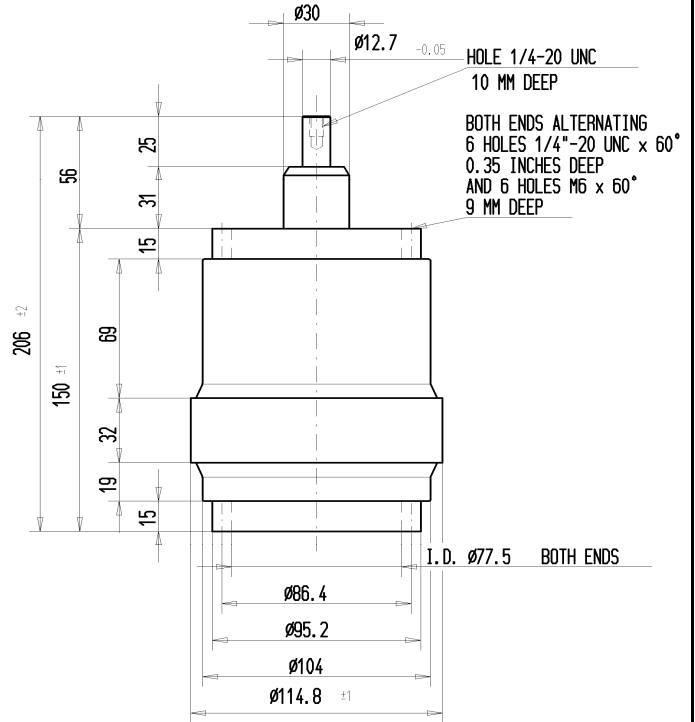
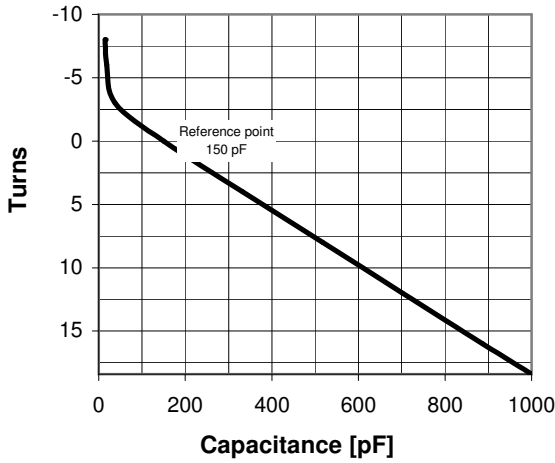

$I_{max}$  at 25°C ambient and 125°C surface temp. for convection cooling

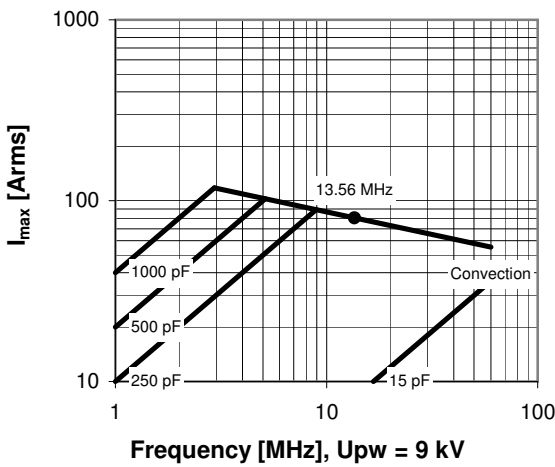

Turns	Nominal Capacitance [pF]	Tolerance
-8.0	15.0	5%
-6.0	18.6	5%
-3.0	37.6	5%
0.0	150.0	0%
4.0	331.9	3%
8.0	516.9	3%
12.0	701.9	3%
16.0	886.9	3%
18.4	1000.0	3%

Mechanical stop at < 15 pF at ~ -12.5 turns  
Mechanical stop at > 1000 pF at ~ 18.7 turns

Self inductance and resonance frequency

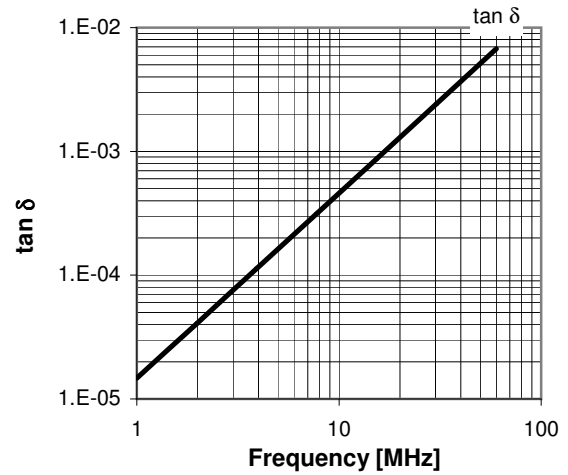
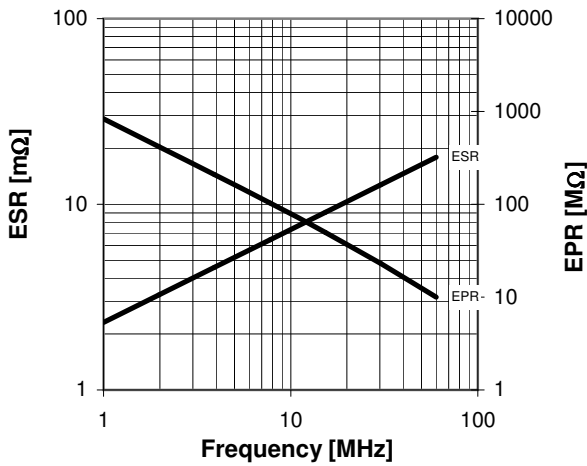
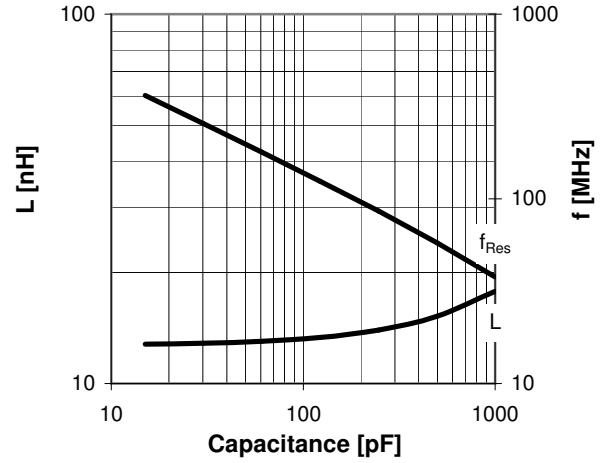

**Special Features:**

Capacity Tolerance 3%